

Magic, Beauty & Mystery

Exploring the glories of
the great pottery churches

SAVE Lecture by Matthew Rice

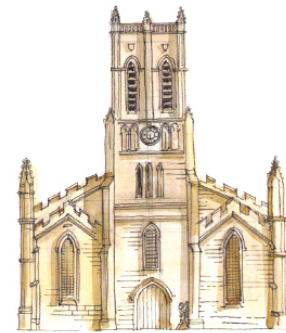
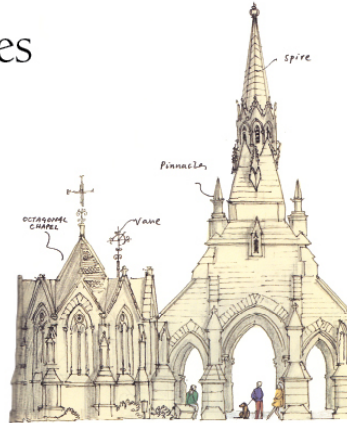
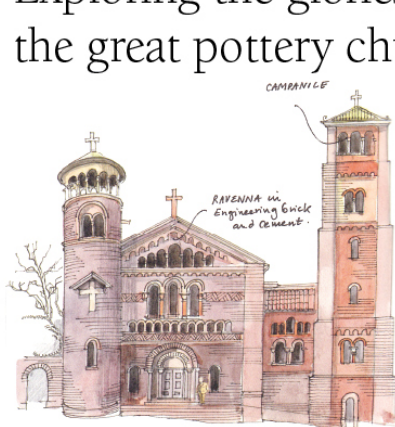
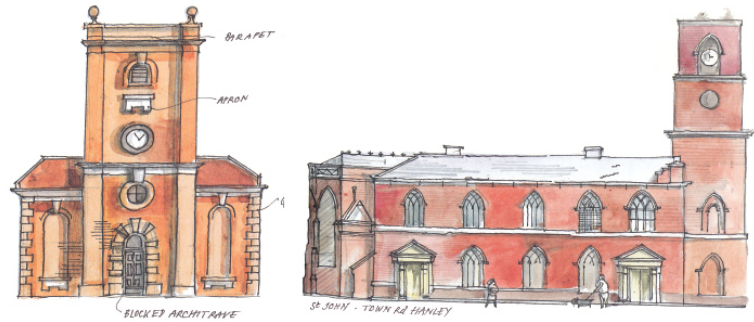

26 November 2013

Tuesday 26th November 2013

St Mary Abchurch, Abchurch Lane,
London, EC4N 7BA

(Bank or Cannon Street are nearest tubes.)

With thanks to The Friends of the City Churches

Lecture: 7.30pm / **Drinks:** 8.30pm

Tickets: £15

Please send a cheque made out to SAVE Britain's Heritage, to:
SAVE, 70 Cowcross Street, London EC1M 6EJ

or pay online via our website using Paypal and drop us a line or call
us to let us know you have done this. Seats are limited.

All money raised from tickets will go towards core funding for SAVE
Britain's Heritage.

SAVE has been campaigning for historic buildings since 1975.
SAVE is a strong, independent voice in conservation, free to
respond rapidly to emergencies and to speak out loud for the
historic environment.

We receive no public funding and rely entirely on private
donations and subscriptions.

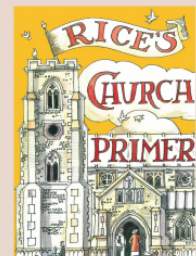

Matthew Rice is a painter, author and
architectural enthusiast. He the author of
Rice's Church Primer, Rice's Architectural
Primer, Building Norfolk and Lost City
of Stoke.

SAVE
BRITAIN'S HERITAGE

T: 020 7253 3500
office@savebritainsheritage.org
www.savebritainsheritage.org